

STREETMAP

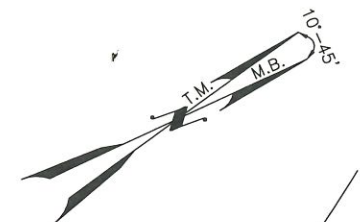
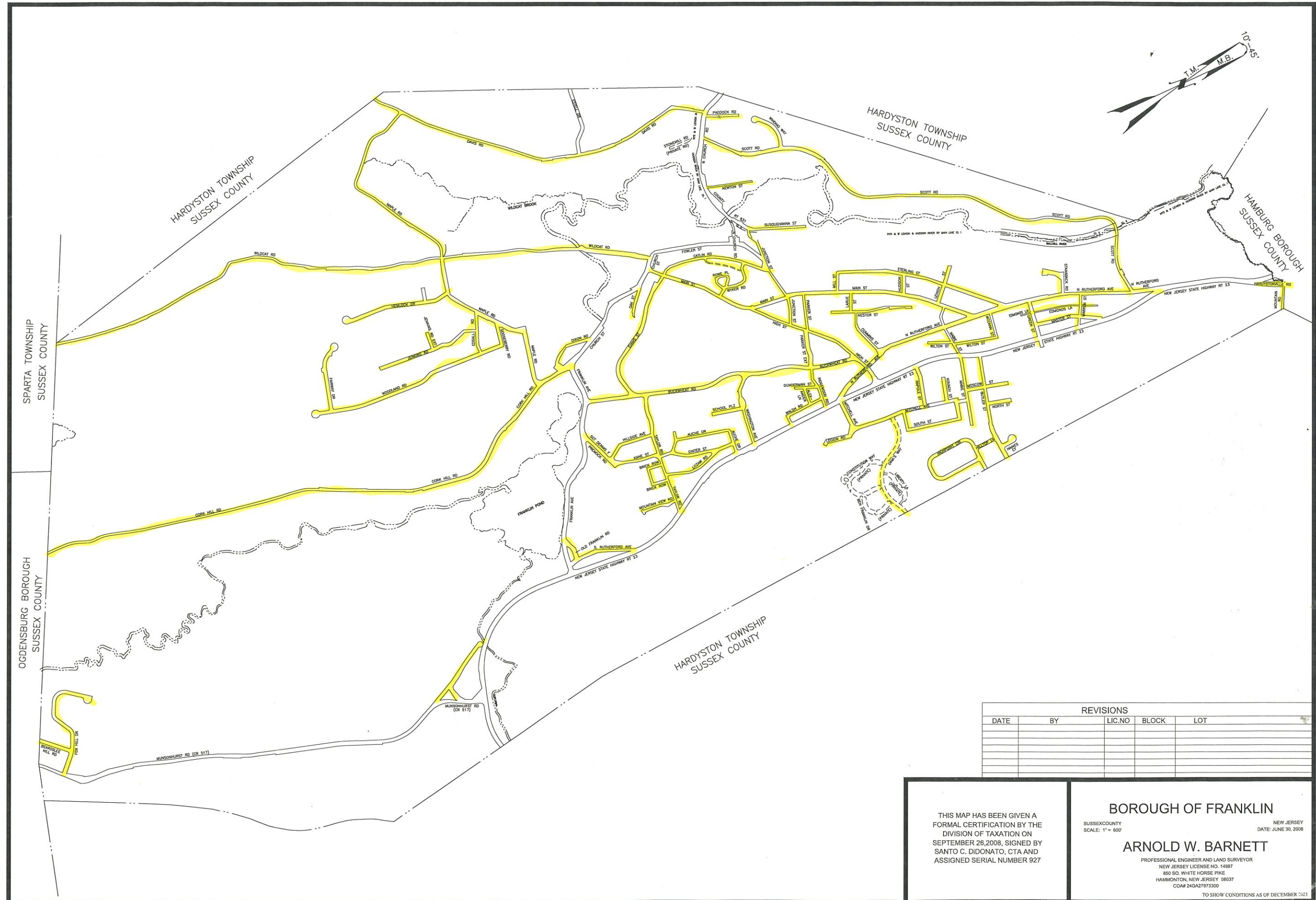

REVISIONS				
DATE	BY	LIC.NO	BLOCK	LOT

THIS MAP HAS BEEN GIVEN A FORMAL CERTIFICATION BY THE DIVISION OF TAXATION ON SEPTEMBER 26, 2008, SIGNED BY SANTO C. DIDONATO, CTA AND ASSIGNED SERIAL NUMBER 927

BOROUGH OF FRANKLIN
 SUSSEX COUNTY
 SCALE: 1" = 600'
ARNOLD W. BARNETT
 PROFESSIONAL ENGINEER AND LAND SURVEYOR
 NEW JERSEY LICENSE NO. 14987
 850 SQ. WHITE HORSE PIKE
 HAMMONTON, NEW JERSEY 08037
 COAR 24GA27973300
TO SHOW CONDITIONS AS OF DECEMBER 2021

STREETMAP